



## VRLA Battery **SPA 6-8**

**Specifications**

**Nominal Voltage** 6 V

<b>Rated Capacity (25 °C)</b>	<b>20hr Rate (1,80V/cell)</b>	<b>10hr Rate (1,80V/cell)</b>	<b>5hr Rate (1,70V/cell)</b>	<b>1hr Rate (1,60V/cell)</b>	
	8 Ah	7,4 Ah	6,4 Ah	5,44 Ah	
<b>Dimensions (mm) &amp; Weight (kg)</b>	<b>Length</b>	<b>Width</b>	<b>Height</b>	<b>Overall Height</b>	<b>Weight</b>
	98mm	56mm	117mm	117mm	1,69kg
<b>Number / Type of Terminals</b>	2 / F1				

### Technical Characteristics

<b>Design Life at 20°C</b>	5 years	
<b>Eurobat Classification</b>	Standard Commercial	
<b>Internal Resistance (Fully charged - 25°C)</b>	13 mΩ	
<b>Short-circuit current</b>	400 A	
<b>Max Charging Current</b>	3,2 A	
<b>Min safe end Discharge Voltage</b>	1,60 V/cell	
<b>Self discharge per month at 20°C</b>	3%	
<b>Recommended Charging Voltage at 20°C</b>	Stand-by use (V/cell): 2,25 to 2,30	Cycle use (V/cell): 2,40 to 2,50
<b>Container Material</b>	ABS-UL94 HB	
<b>Electrolyte Type</b>	Sulfuric Acid	
<b>Type of plates / Alloy</b>	Flat plates / Lead-Calcium-Tin alloy	
<b>Type of Separator</b>	Absorbant Glass Mat	
<b>Valve Type / Operational Pressure</b>	Rubber / 1-3 psi (70-200 mbar)	
<b>Operating Temperature Range</b>	-20 to +50°C	
<b>Storage time at 20°C</b>	9 months	

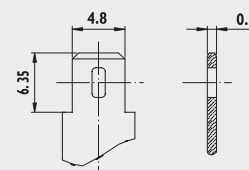
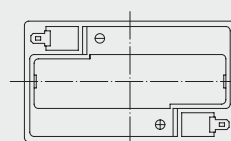
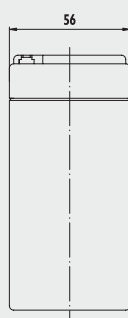
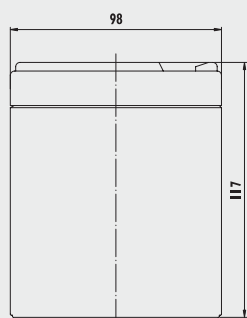

Terminal F1