



VRLA Battery SPA 6-4.5

Specifications	Nominal Voltage	6 V				
	Rated Capacity (25 °C)	20hr Rate (1,80V/cell)	10hr Rate (1,80V/cell)	5hr Rate (1,70V/cell)	1hr Rate (1,60V/cell)	
		4,5 Ah	3,2 Ah	3,6 Ah	3,06 Ah	
	Dimensions (mm) & Weight (kg)	Length	Width	Height	Overall Height	Weight
		70mm	47mm	101mm	107mm	0,92kg
	Number / Type of Terminals	2 / F1				

Technical Characteristics

Design Life at 20°C	5 years	
Eurobat Classification	Standard Commercial	
Internal Resistance (Fully charged - 25°C)	22 mΩ	
Short-circuit current	250 A	
Max Charging Current	2 A	
Min safe end Discharge Voltage	1,60 V/cell	
Self discharge per month at 20°C	3%	
Recommended Charging Voltage at 20°C	Stand-by use (V/cell):	2,25 to 2,30
	Cycle use (V/cell):	2,40 to 2,50
Container Material	ABS-UL94 HB	
Electrolyte Type	Sulfuric Acid	
Type of plates / Alloy	Flat plates / Lead-Calcium-Tin alloy	
Type of Separator	Absorbant Glass Mat	
Valve Type / Operational Pressure	Rubber / 1-3 psi (70-200 mbar)	
Operating Temperature Range	-20 to +50°C	
Storage time at 20°C	9 months	

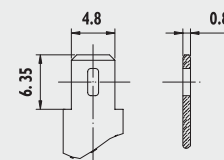
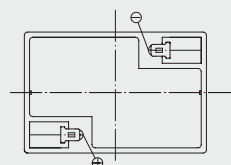
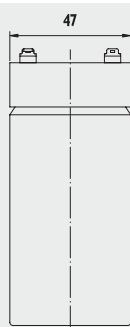
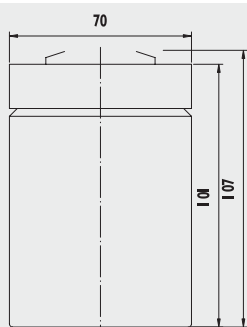

Terminal F1